



Flat 6, Craig House Marmion Avenue

, Southsea, PO5 2BL

Offers in excess of £160,000

No Forward Chain | Parking Space | Close to the Beach
| Close to Local Amenities | Perfect for First Time Buyers |
Long Lease | Ideal for Investors

- No Forward Chain
- Parking Space
- Close to the Beach
- Close to Local Amenities
- Perfect for First Time Buyers
- Long Lease
- Ideal for Investors

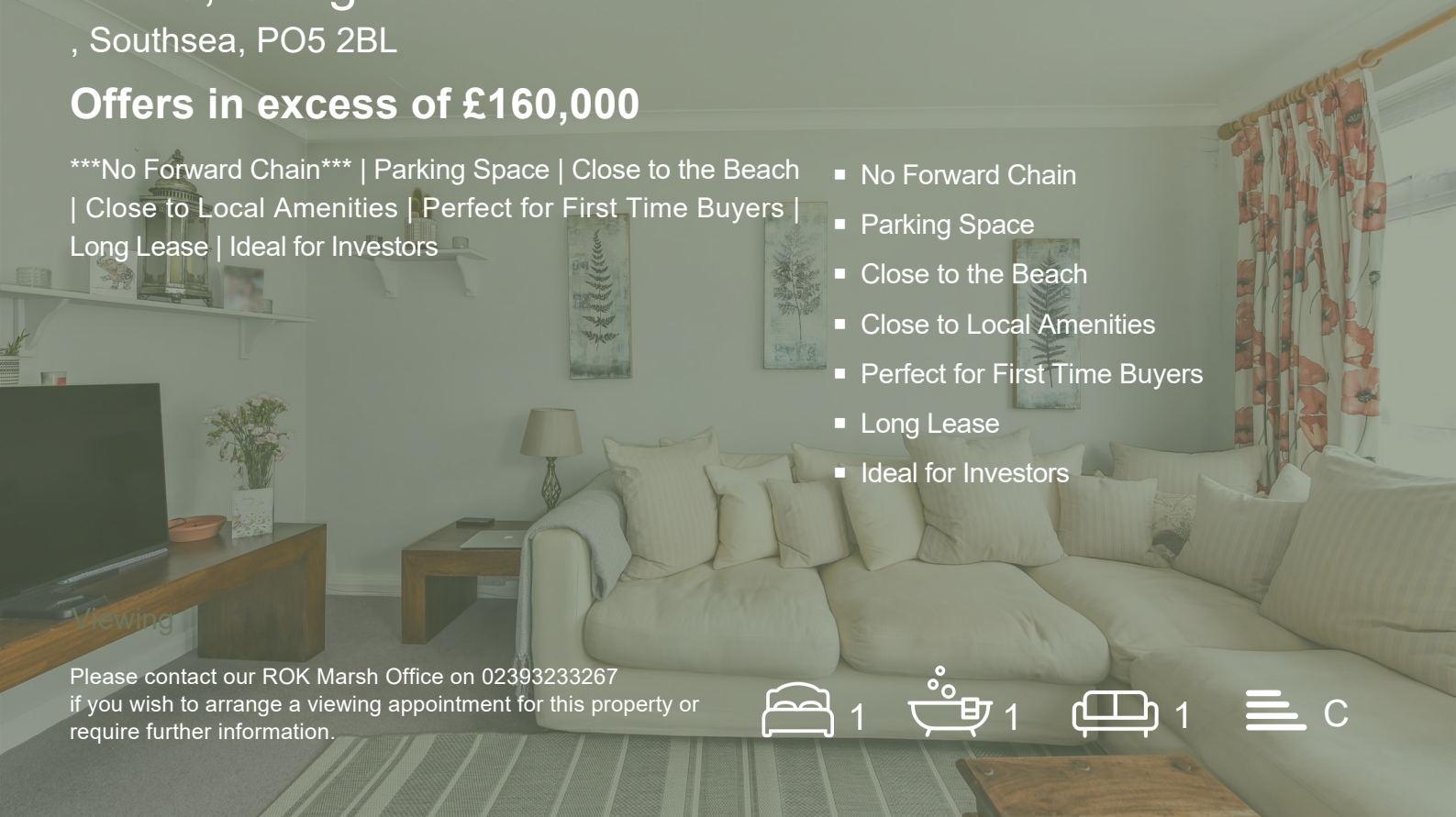

Viewing

Please contact our ROK Marsh Office on 02393233267
if you wish to arrange a viewing appointment for this property or
require further information.



1



1



1



C

Floor Plan

Area Map

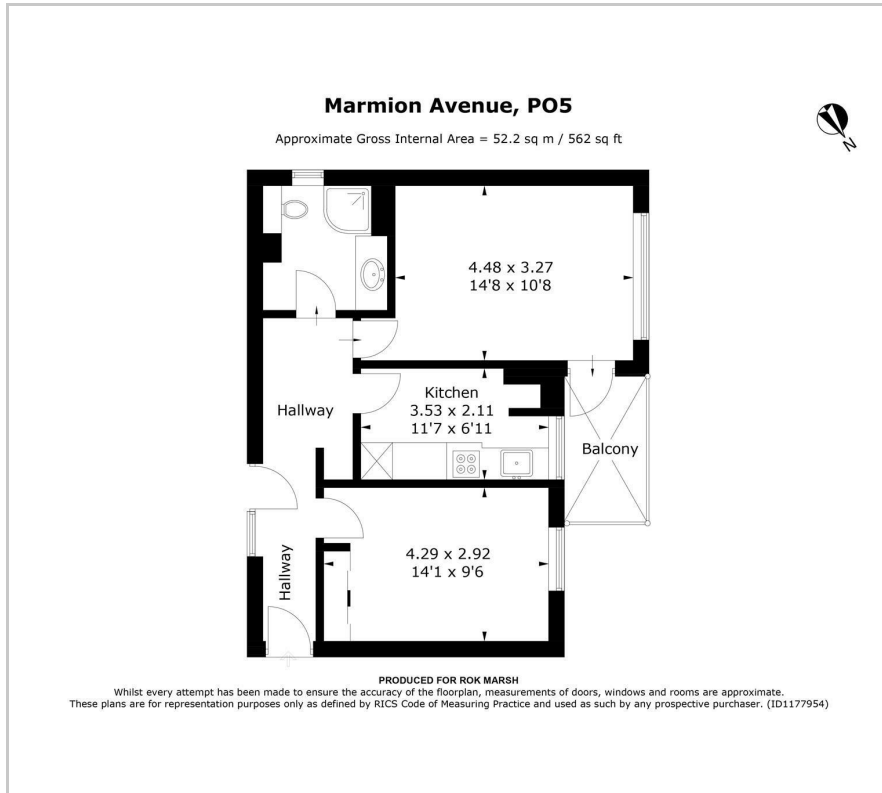

Energy Efficiency Graph

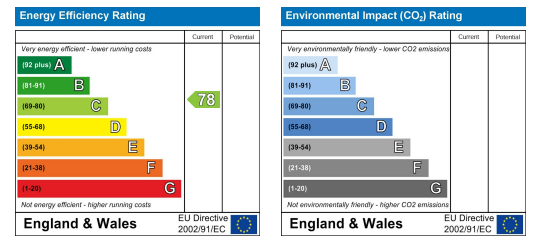

These particulars, whilst believed to be accurate are set out as a general outline only for guidance and do not constitute any part of an offer or contract. Intending purchasers should not rely on them as statements of representation of fact, but must satisfy themselves by inspection or otherwise as to their accuracy. No person in this firm's employment has the authority to make or give any representation or warranty in respect of the property.